

การประเมินความเสี่ยงตามมาตรฐาน EN 13849-1

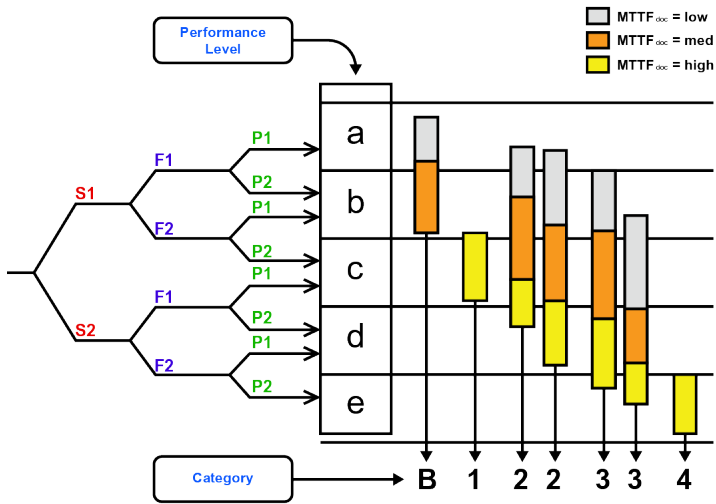

PAScal® Safety Calculator - Calculation software for verifying functional safety

Determine the safety levels of safety functions with ease - with the Safety Calculator PAScal you have a handy calculation tool to verify functional safety in accordance with EN ISO 13849-1 and EN/IEC 62061.

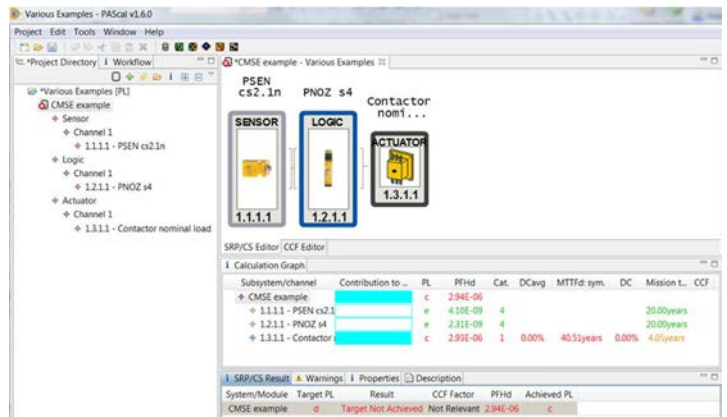

- S = ความรุนแรงของการบาดเจ็บ
- S1 = บาดเจ็บเล็กน้อย
- S2 = ได้รับความเจ็บสาหัส รวมถึงเสียชีวิต
- F = ความถี่ต่อการสัมผัสความอันตราย
- F1 = ไม่ค่อยบ่อยหรือสัมผัสอันตรายในระยะสั้น
- F2 = บ่อยอย่างต่อเนื่อง หรือสัมผัสอันตรายในระยะเวลาที่ยาวนาน
- P = ความเป็นไปได้ในการหลีกเลี่ยงอันตราย
- P1 = ความเป็นไปได้ในการหลีกเลี่ยงอันตราย
- P2 = แทบจะเป็นไปไม่ได้

Specification of categories / subsystem types

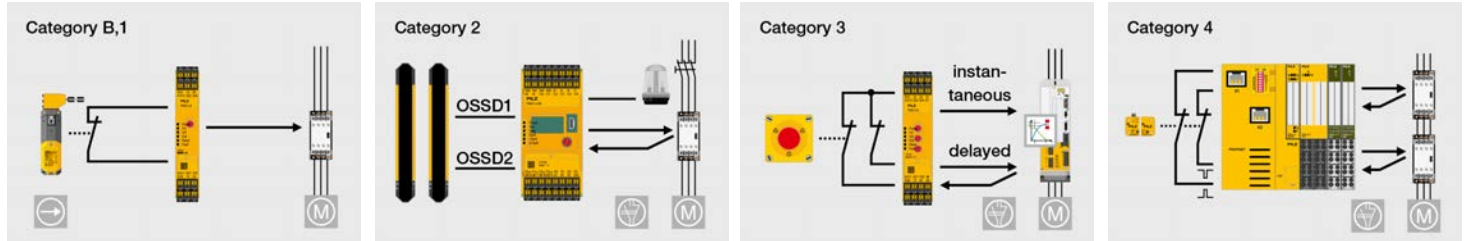

Safety Services



PILZ

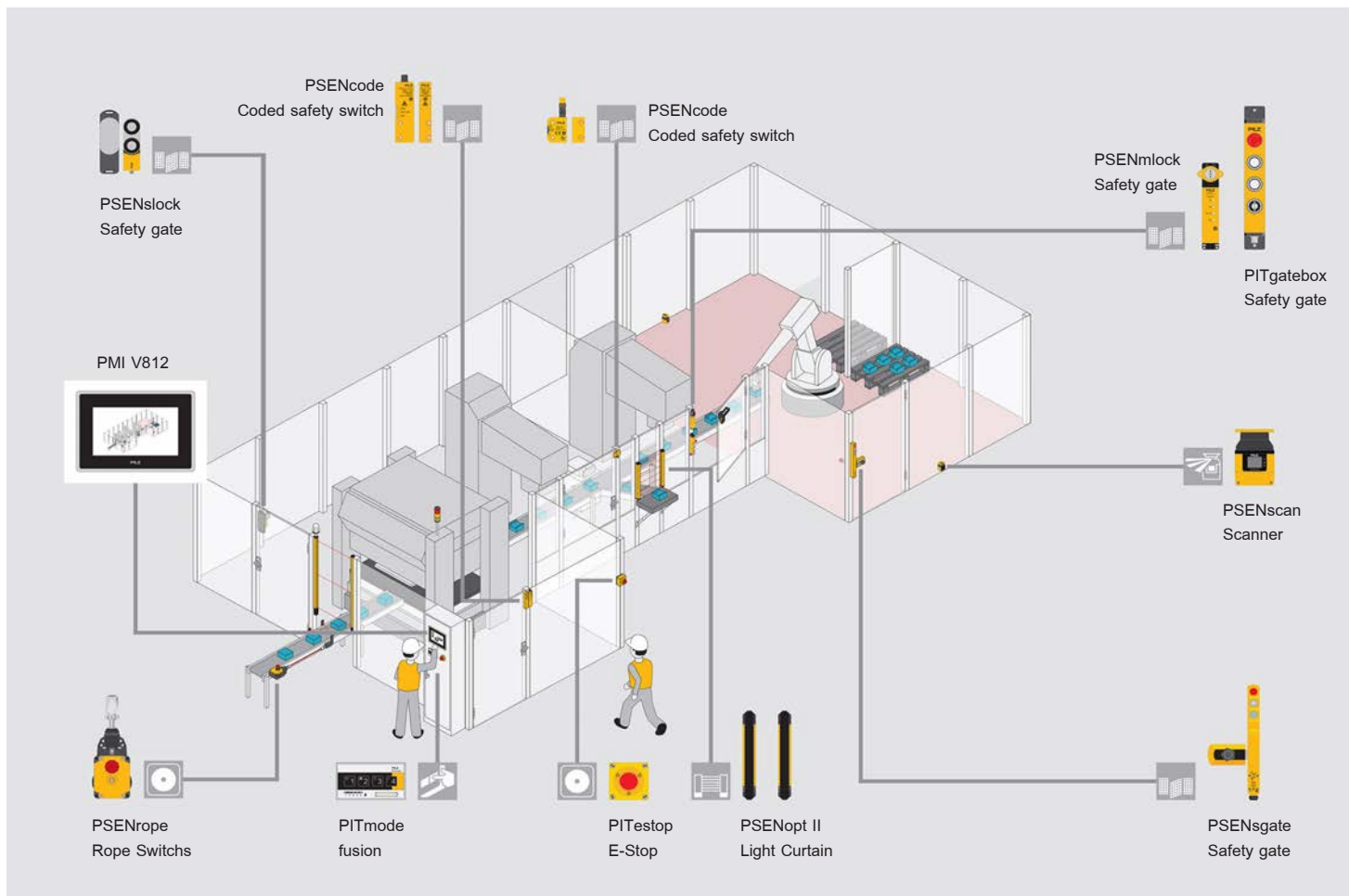

Safe sensor technology PSEN



PSEN CS3.1
Coded
Connector : M12, 8-pin
Order number : 541009

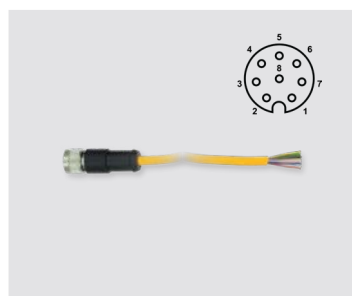

PSEN cable M12-8sf
Straight, M12, 8pin, socket
Order number : 540319(3m),
540320(5m), 540321(10m)



PSEN 1.1p-20/PSEN 1.1-20
Contact : 2NO
Distance : 8 mm
Connector : M8, 4-pin
Order number : 504220

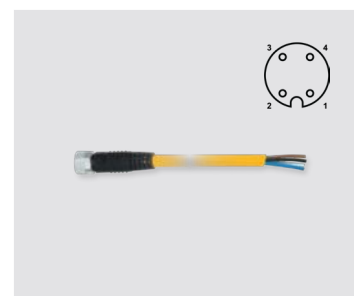

PSEN cable M8-4sf
Straightplug, M8,4-pin
Order number : 533111(2m),
533121(5m), 533131(10m),
533141(30m)

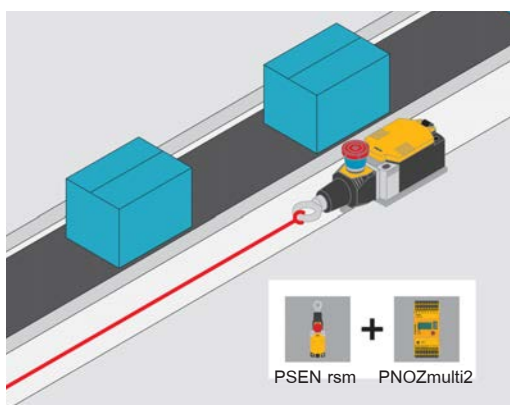

PSEN rsm + **PNOZmulti2**



PSEN rsm 1.0-300-0-0-0
Housing material : Al die cast
Contacts : 2NC, 2NO
Order number : 570304



PSEN rs pulley flex
Block rope pulley, rotatable
Order number : 570313

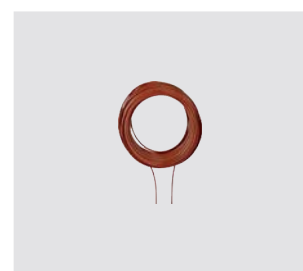

PSEN rs pulley flex
Block rope pulley, rotatable
Order number : 570313



PSEN b5/me5
Mechanical bolt for safety switch
PSEN me5 with options for escape release.
Order number : 6L000023

PSEN me5S (24V AC/DC)
Spring force, บานสไลด์, บานสวิงค์
Contacts : NC.NC-NC
Connector : M12-8pin
Holding force : 1500 N
Extraction force : min. 10 N
Order number : 6L000019

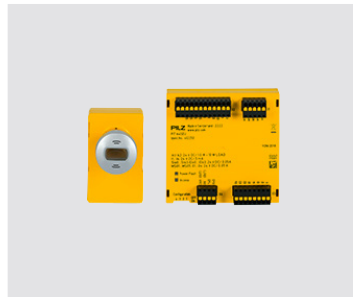

PMI V807 / PMI V812
Capacitive glass touchscreen
Diagonal : 7", 12.1"
Resolution : 800 x 480 pixels(7"),
1,200 x 480 pixels(12.1")

PITmode fusion
Order number : 402251
* PITreader key Page number 4

PIT es Set1s-5s
Contact : 2NC with monitoring
Order number : 400447

PSEN sc L 5.5 08-12
8 or 12-pin exchangeable memory module
range safety : 5.5m
Order number : 6D000013

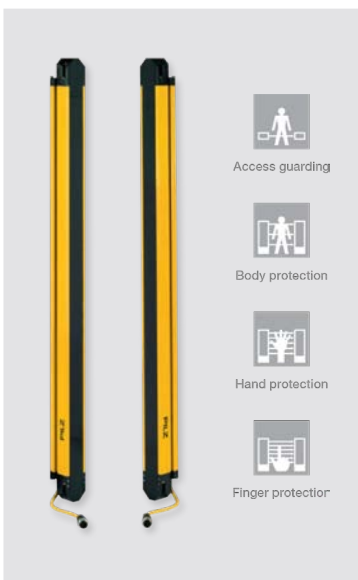
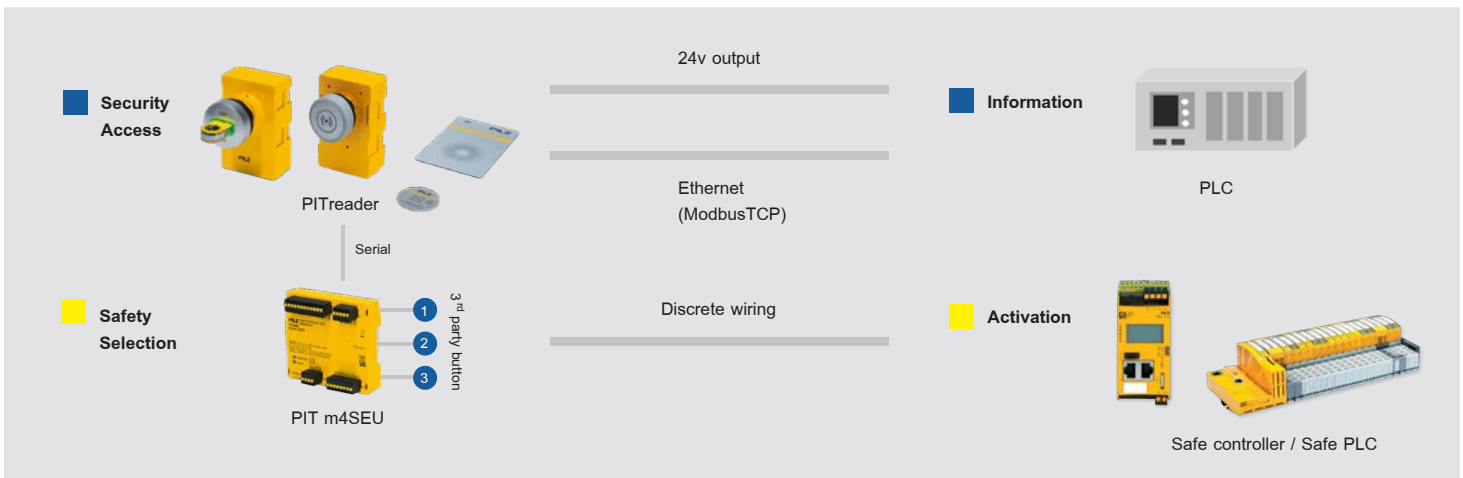

Type code for PSENopt II
PSEN opl13H-s-30-045

Product area Pilz Sensors	Approval	Resolution	Function	Resolution	Height of protected field
Operation Non-contact, optical, 2D (area monitoring) With safe semiconductor outputs	3 Type 3 4 Type 4	B Body protection H Hand protection F Finger protection	S Standard	14 14mm 30 30mm 170 170mm ³⁾ 300 300mm ⁴⁾	015 150mm 030 300mm 045 450mm 060 600mm 075 750mm 090 900mm 105 1050mm 120 1200mm 135 1350mm 150 1500mm 165 1650mm 180 1800mm
Connection Receiver: 1 x pigtail, M12, 5-pin Transmitter: 1 x pigtail, M12, 5-pin No dead zones (except with protected field height 150 mm)				Order number 5m 630311 10m 630312 20m 630298	

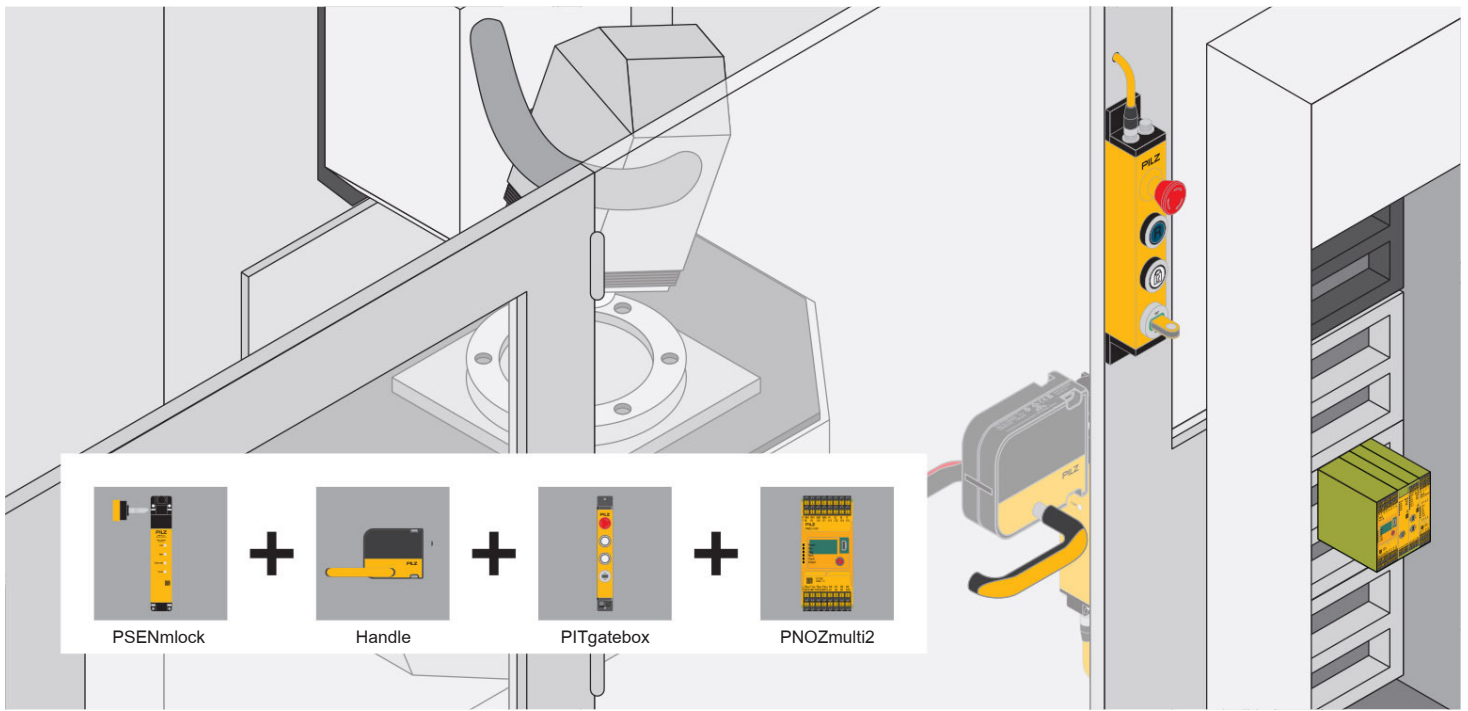

Modular safety gate system

PILZ



PSEN ml ba 1.1
 coded, fully coded
Holding force : 7500 N
Connection type : M12, 8pin
Order number : 570424, 570426



PIT gb LLE
E-STOP pushbuttons : 2NC, 1NO
Position 1,2,3 : illuminated (1NO)
Connection type : M12, 12pin
Order number : G1000001

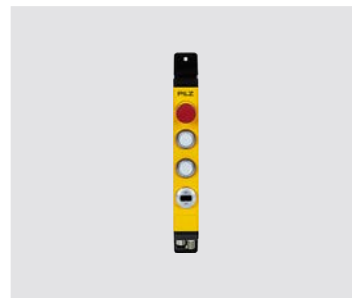

PIT gb RLLE down ETH
E-STOP pushbuttons : 2NC, 1NO
Position 1,2 : illuminated (1NO)
Position 3 : PITreader (1NO)
Connection type : M12, 12pin
Order number : G1000021



PITreader key
 authorisation for operating mode 1,2,3,4,5
Material: Plastic
Order number : 402261, 402262, 402263, 402264, 402265

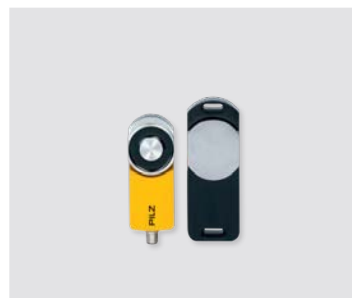
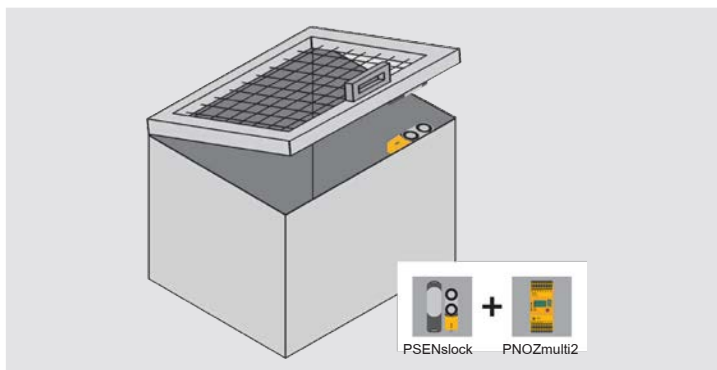

PSEnlock
 Series connection, 500 N

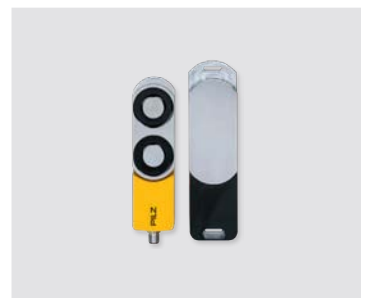

PSEnlock
 Series connection, 1000 N

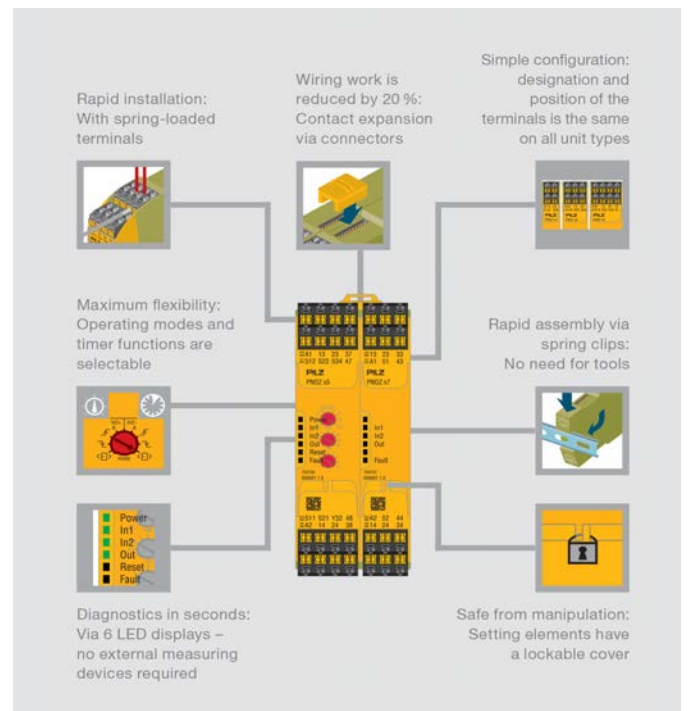
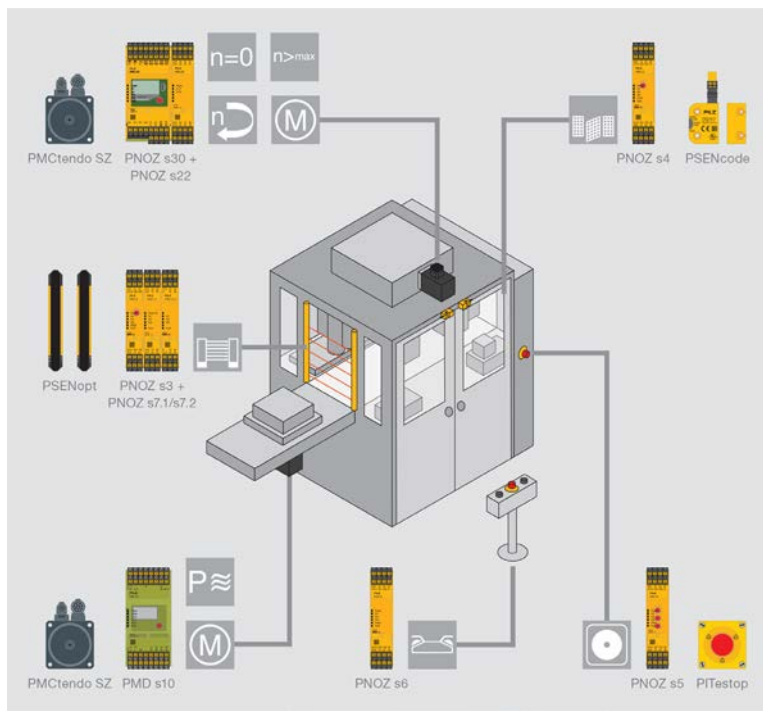

Safety relays PNOZsigma

Type	Application	PL-EN ISO138491	(SIL) CL-with IEC62061	Output contacts		Supply Voltage (U _B)	Housing width in mm		
				Safe	Auxiliary				
PNOZ s1	• •	c	2	2	-	1	24 VDC	12.5	
PNOZ s2	• •	e	3	3	-	1	1	24 VDC	17.5
PNOZ s3	• • •	e	3	2	-	-	1	24 VDC	17.5
PNOZ s4	• • •	e	3	3	-	1	1	24 VDC, 48 ... 240 VAC/DC	22.5
PNOZ s4.1	• • •	e	3	3	-	1	1	24 VDC, 48 ... 240 VAC/DC	22.5
PNOZ s5	• • • •	e	3	2	2	-	1	24 VDC, 48 ... 240 VAC/DC	22.5
PNOZ s6	EN 574, Type IIIC •	e	3	3	-	1	1	24 VDC, 48 ... 240 VAC/DC	22.5
PNOZ s6.1	EN 574, Type IIIA •	c	1	3	-	1	1	24 VDC, 48 ... 240 VAC/DC	22.5
PNOZ s7	Contact expansion	e	3	4	-	1	-	24 VDC	17.5
PNOZ s7.1	Contact expansion	e	3	3	-	-	-	24 VDC	17.5
PNOZ s7.2	Contact expansion	e	3	4	-	1	-	24 VDC	17.5
PNOZ s9	Contact expansion or safe timer relay •	e	3	-	3	1	-	24 VDC	17.5
PNOZ s10	Contact expansion	e	3	4	-	1	-	24 VDC	45.0
PNOZ s11	Contact expansion	e	3	8	-	1	-	24 VDC	45.0
PNOZ s22	Contact expansion for PNOZ s30 and PNOZ mm0.1p/mm0.2p	e	3	2x3	-	2x1	-	24 VDC	22.5
PNOZ s30	Speed monitor	e	3	2	-	2	4	24 VDC	45.0

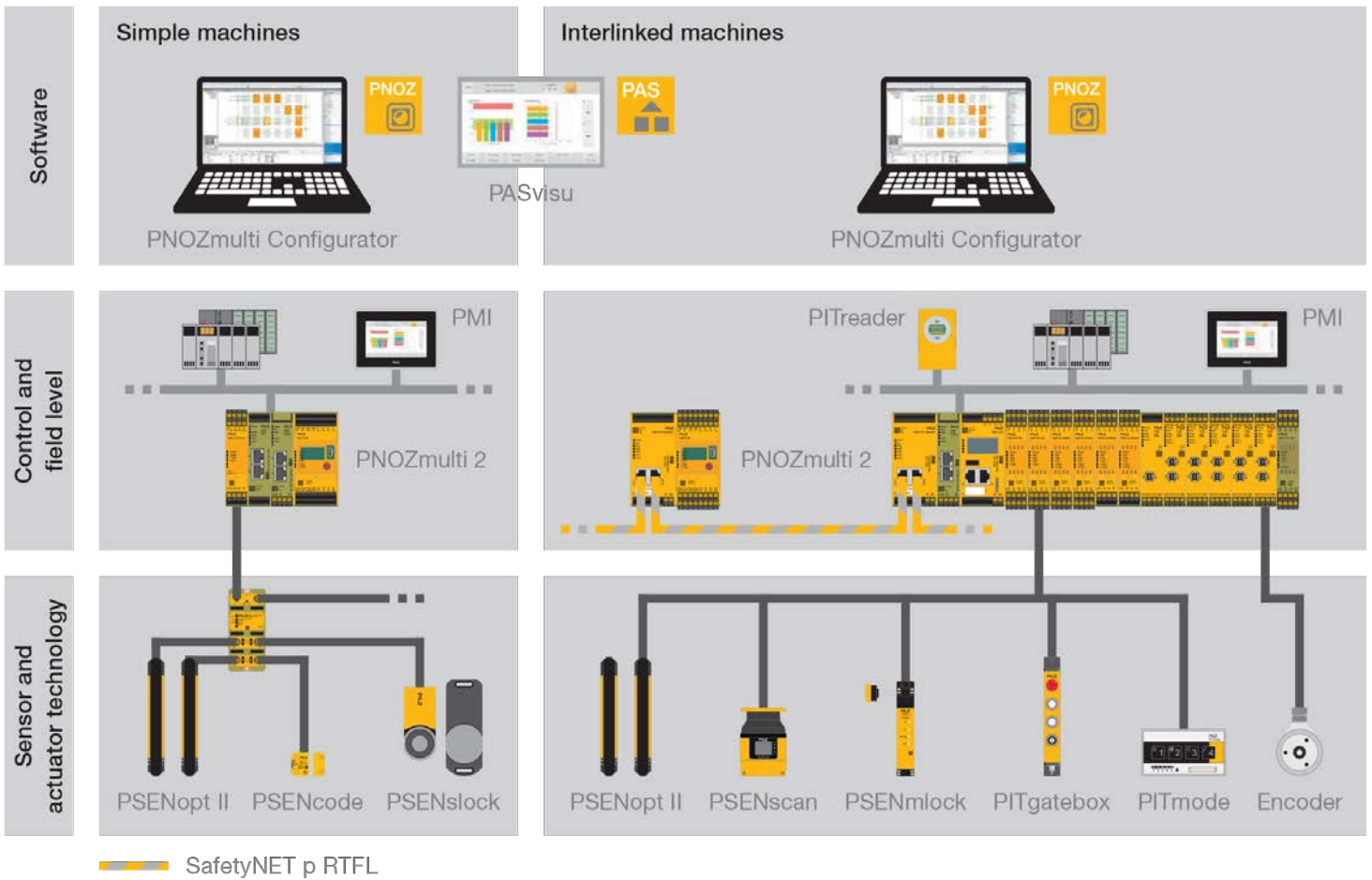

Configurable control systems PNOZmulti 2

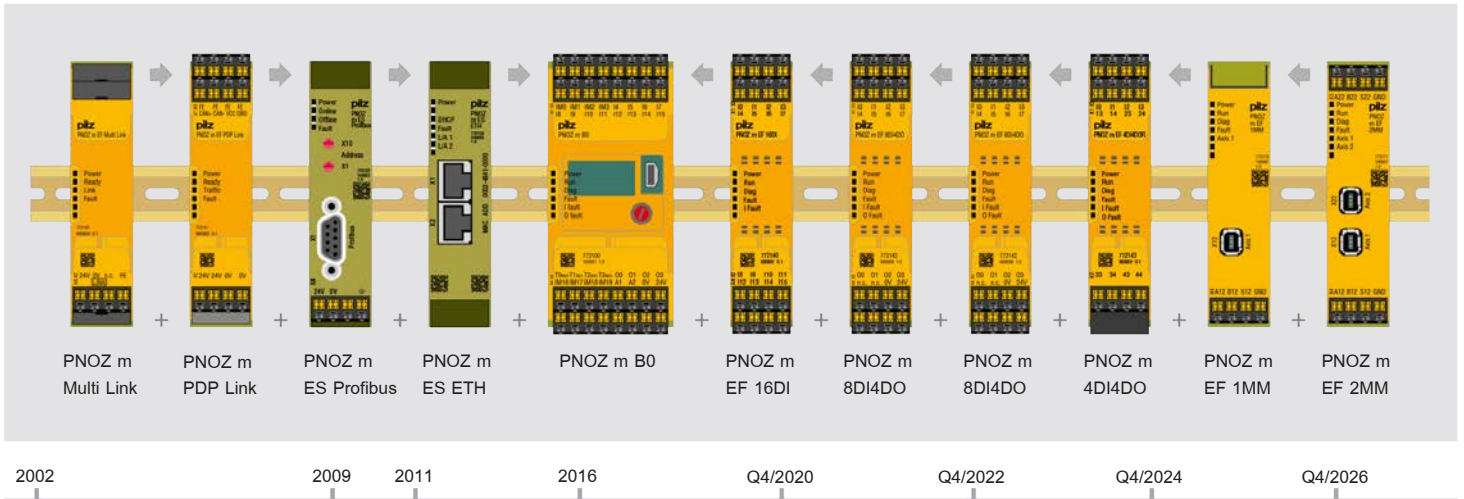

Obsolete 2024



PNOZmulti 2

Automation system PSS4000

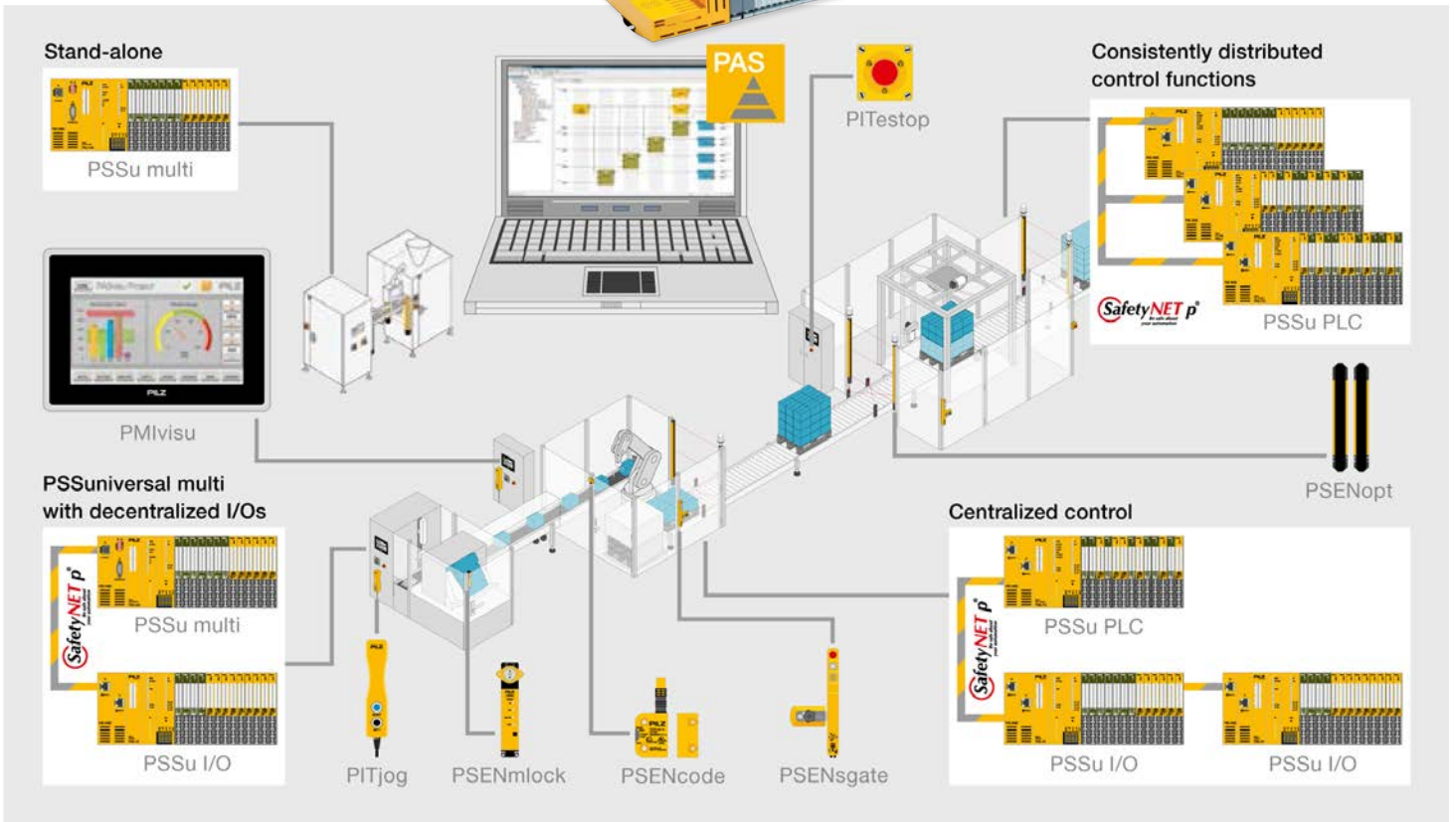

myPNOZ Create your safety

my PNOZ®
create your safety



reddot winner 2022

PILZ

